



THE NEWEST & NEAREST TRACK IN SPAIN

Circuito de
Navarra





CONTENTS

Introduction	
Main circuit	
Karting track	
Safety driver training track	
Boxes	
Media centre	
Briefing room	
Team catering	
Hospitality suites	
Vip hospitality suites	
Restaurant	
Conference room	
Navarra	
Location	



INTRODUCTION

The all-new Navarra Circuit is the only race track in north western Spain and is a multipurpose motor sports facility with a comprehensive array of the latest thinking in circuit design and planning. Navarra's combination of track layouts, the quality of the pits and paddock, its offices and hospitality suites, the superb circuit viewing and easy access, provide excellent facilities for motorsports professionals, private teams and track day enthusiasts.

Its longest layout offers the full 3.9 km track, certified by the FIA and the FIM, and is ideal for testing everything from F1 cars to a manufacturer's new economy street model, or from Superbikes to bike track days. Throughout the season, there will be regular race meetings at regional, national and international car and motorbike championship levels.

With its multiple facilities:- 2 track layouts for simultaneous use, a 730m race track for karts, mini-motos and supermotards, as well as the innovative specialist 950m skid pan with its dedicated sprinkler system for safe driving courses, make it the perfect venue for all kinds of corporate and road training events.

The circuit's amenities for the race track user – 32 first class pit garages; the race control tower, briefing room, media centre and 17 hospitality suites are complemented by similar standards for the leisure visitor - a restaurant and hospitality building with spectacular views of the race track's main straight.

The Circuit is located in the beautiful region of Navarra, offering a wide variety of picturesque scenic routes, an ample selection of hotels and lodging accommodation, spectacular wineries and superb culinary products and is the perfect destination for all kinds of multi-activity programs.



TRACKS

MAIN CIRCUIT

The Speed Circuit is a unique track in the north-west of Spain, qualified to hold regional, national and international races, not to mention first-class car and motorcycle testing procedures. A varied track has been designed to create distinct sensations for drivers thanks to the combination of fast, slow and more technical stretches.

In addition to official sports competitions, testing and track days, the track at the Circuit of Navarra is designed so that two circuits can be used at the same time thanks to the division of the course, creating two different tracks: one which is 2.7-km and one which is 1.3-km long. It is, therefore, a multifunctional Speed Circuit.

TECHNICAL CHARACTERISTICS

- ▶ **Certifications:**
 - FIA T1 & Grade 2
(testing up to and including F1 & GP2 races)
 - FIM Grade B
(Superbikes races)
- ▶ **Total length: 3.933 m.**
- ▶ **Two simultaneous tracks (2,6km y 1,3km)**
- ▶ **Circuit width: from 15 m. to 12 m.**
- ▶ **Main straight: 800 m.**
- ▶ **Turns: 15 (6 left y 9 right)**
- ▶ **Paddock: 41.000 m²**
- ▶ **Maximum speed (F1): 314 km/h.**



TRACKS

KARTING TRACK

The Circuit of Navarra has one of the finest outdoor karting tracks in the whole North of Spain-South of France region. A safe, modern facility, users can make the most of a wide range of Karts for all levels, from children through to amateurs and experts.

The Circuit of Navarra Karting track is designed not just for regional and national sports competitions, but also for leisure activities for the general public, organised groups and companies.



TECHNICAL CHARACTERISTICS

- ▶ Track length: 731 m.
- ▶ 15 turns: 9 right, 6 left
- ▶ Width: From 10 m. to 8 m.
- ▶ Briefing room, changing rooms and showers.
- ▶ Kart storage area
- ▶ Night illumination
- ▶ Timing system
- ▶ Paddock
- ▶ Parking



TRACKS

SAFETY DRIVER TRAINING TRACK

The skidpan area at the Circuit of Navarra is one of the Circuit's most important work areas for the general public. The facility is available for safe driving, sports driving, road safety, advanced driving skills and drifting practice and courses, among others. Companies (both public and private) can also sign up for theory-practical courses, Road Safety audits and training plans, also being able to set up shop at the Circuit of Navarra thanks to the availability of building space and garages.

The area consists of a fully equipped pad with low-grip driving surface and fitted with sprinklers over the entire length of its 950-metre track.

TECHNICAL CHARACTERISTICS

- ▶ Total surface area: 14.000 m²
- ▶ Length: 950 m.
- ▶ Drifting circle: 40 m. diameter
- ▶ Surface: polished concrete
- ▶ Sprinkler and water recuperation system



PIT GARAGE BUILDING

BOXES

PIT GARAGE BUILDING PIT GARAGES

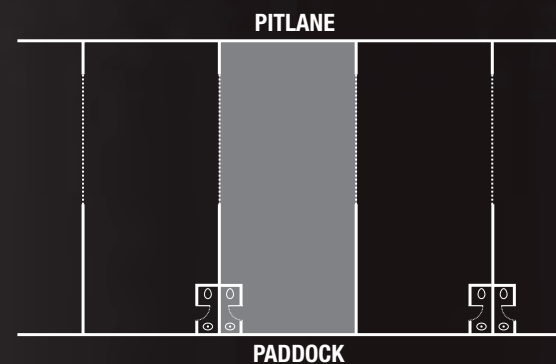

Total N° of Boxes: 29 in
3 modules
Size: 105 m2 (7 x 15 m)
Wifi and TV connection
Interconnected
Toilet



PIT GARAGE BUILDING

MEDIA CENTRE

PIT GARAGE BUILDING MEDIA CENTER

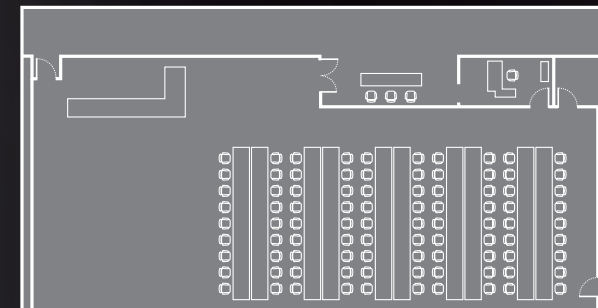

Size: 300 m
Capacity: 150 people
TV monitors: 24
Individual lockers: 50
Individual working stations: 90

Each working stations equipped with power supply and Internet connection

Others:
Full Internet WiFi area
Press officer private office
Information desk

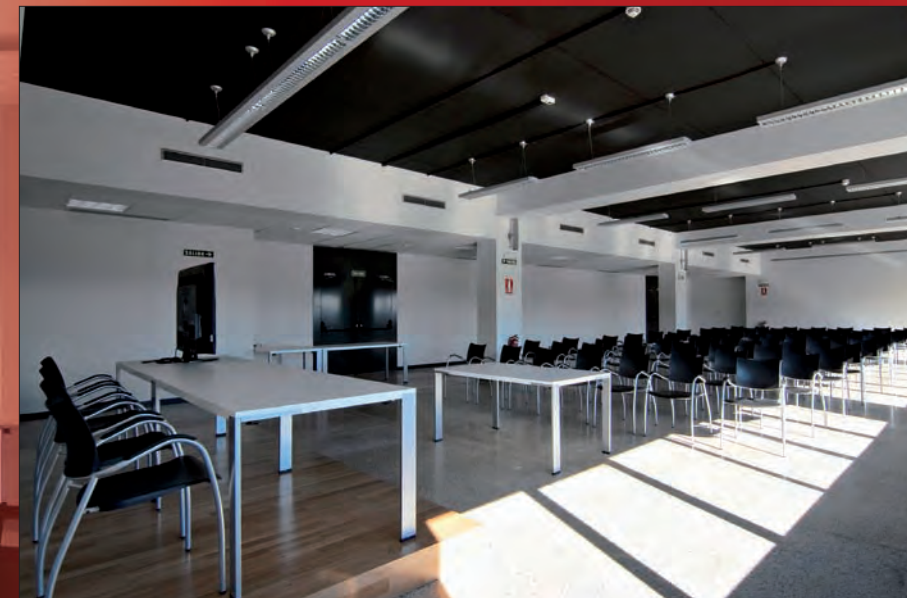

PIT GARAGE BUILDING

BRIEFING ROOM

PIT GARAGE BUILDING **BRIEFING ROOM**

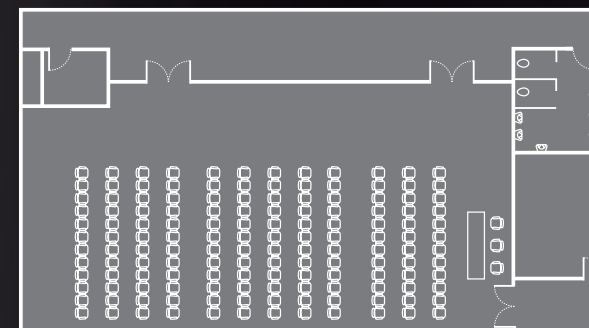

Size: 223 m²
Capacity: 200 people

Includes:
Moderator stage
Video projector with feedback to TV screens
HiFi sound system



PIT GARAGE BUILDING

TEAM CATERING

PIT GARAGE BUILDING **TEAM CATERING**

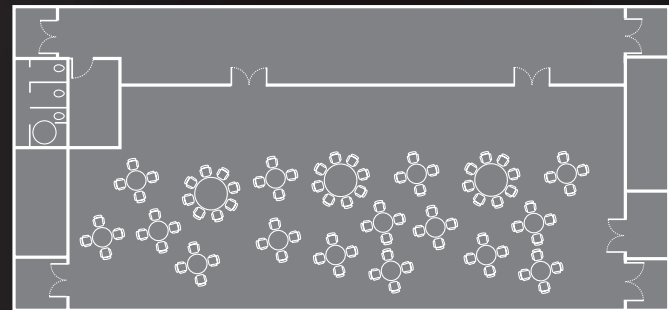
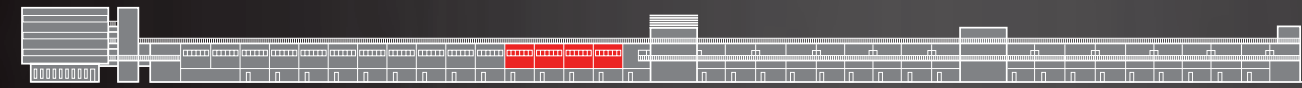

Size: 300 m²
Capacity: 160 people
Located next to kitchen



PIT GARAGE BUILDING

HOSPITALITY SUITES

PIT GARAGE BUILDING **HOSPITALITY SUITES**

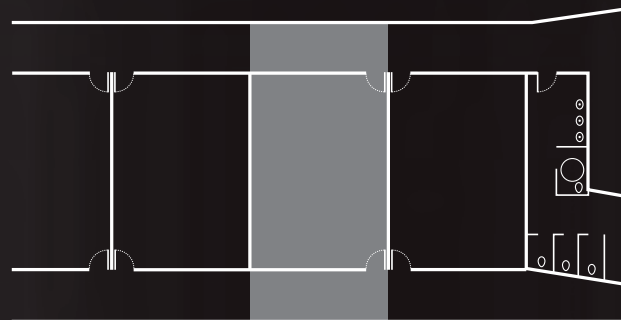

Size: 60 m²
Capacity: 35-40 people
Direct access from Paddock Bar
TV monitors
Private terraces over looking pit lane and paddock



CONTROL TOWER

VIP HOSPITALITY SUITES

CONTROL TOWER **VIP HOSPITALITY SUITES**

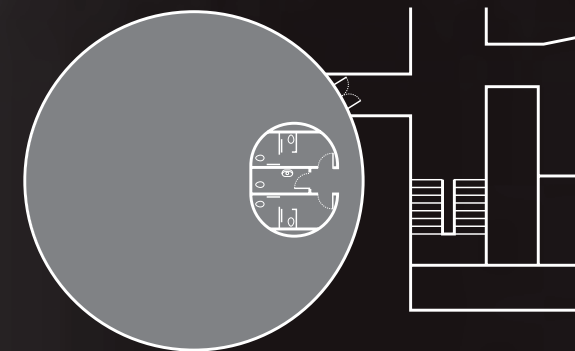

Size: 150 m²
Capacity: 100 people
360° views
TV monitors
Toilets



ATALAYA CENTER

RESTAURANT

ATALAYA CENTER RESTAURANT/CAFETERIA

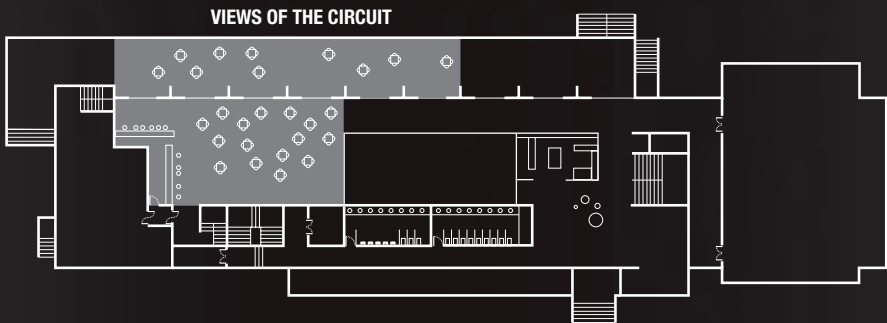

Restaurant capacity: 100 people
1st floor catering hall: 300 people



ATALAYA CENTER

CONFERENCE ROOM

ATALAYA CENTER CONFERENCE ROOM

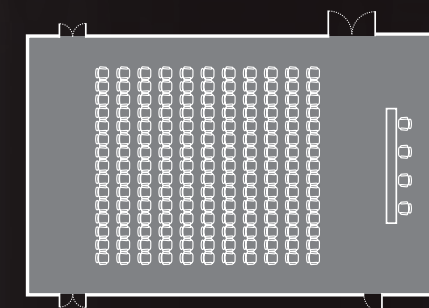

Size: 295 m2
Capacity: 200 personas
Audiovisual equipment: Screen vídeo,
projector and sound system
Direct access of kitchen and catering services
Reception area



DISTANCES TO AIRPORTS
AND MAIN CITIES

- Pamplona: 58 km. on Highway A12
 - Logroño: 28 km. on Highway A12
 - Vitoria: 65 km.
 - San Sebastian: 141 km.
 - Bilbao: 164 km.
 - Zaragoza: 165 km.
 - Biarritz: 187 km.
 - Santander: 262 km.
- International
- International
- International
- International
- International
- International
- International
- International

OTHER INFORMATION

Average number of days without rainfall
per year: 290 days
Average annual rainfall: 473 mm

GPS Coordenates:
Entrance: 42° 33´ 20” N
2° 09´ 53” W
Helipad: 42° 33´ 34” N
2° 10´ 01” W

